

HSK63A ER (DIN6499) Collet Chucks - Standard

CODE	Collet	D	L
HSK63A-ER16-100	ER16	28.0 Hex (25.0 A/F)	100.0
HSK63A-ER25-100	ER25	42.0 Dia	100.0
HSK63A-ER32-100	ER32	50.0 Dia	100.0
HSK63A-ER40-120	ER40	63.0 Dia	120.0

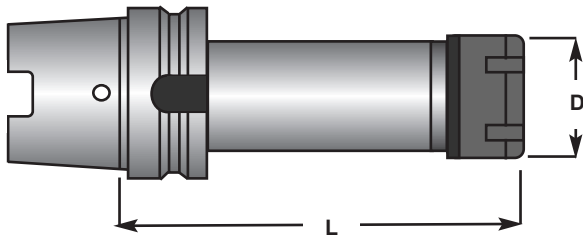

HSK63A ER (DIN6499) Collet Chucks - Extended

CODE	D	L
HSK63A-ER16-160	28.0 Hex (25.0 A/F)	160.0
HSK63A-ER25-160	42.0 Dia	160.0
HSK63A-ER32-160	50.0 Dia	160.0
HSK63A-ER32-200	50.0 Dia	200.0

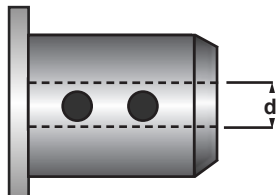
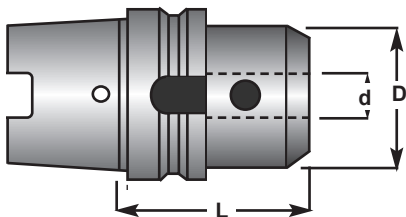

When $d = 25$ & 32 mm - 2 Lockscrews

HSK63A Endmill Adaptors

CODE	d	D	L
HSK63A-EM06-065	6.0	25.0	65.0
HSK63A-EM08-065	8.0	28.0	65.0
HSK63A-EM10-065	10.0	35.0	65.0
HSK63A-EM12-080	12.0	42.0	80.0
HSK63A-EM14-080	14.0	44.0	80.0
HSK63A-EM16-080	16.0	48.0	80.0
HSK63A-EM18-080	18.0	50.0	80.0
HSK63A-EM20-080	20.0	52.0	80.0
HSK63A-EM25-110	25.0	65.0	110.0
HSK63A-EM32-110	32.0	72.0	110.0

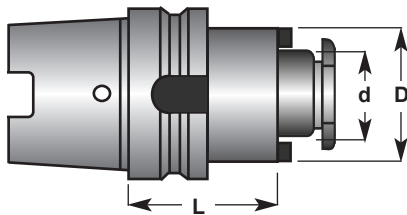

HSK63A Shellmill Adaptors

CODE	d	D	L
HSK63A-SM16-050	16.0	44.0	50.0
HSK63A-SM22-050	22.0	42.0	50.0
HSK63A-SM27-060	27.0	60.0	60.0
HSK63A-SM32-060	32.0	78.0	60.0
HSK63A-SM40-060	40.0	89.0	60.0

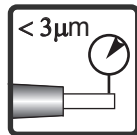
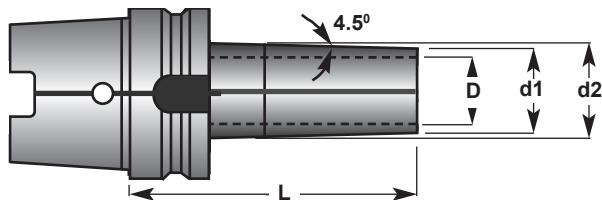

HSK63A Heat Shrink Holders

CODE	D	d1	d2	L
HSK63A-TS03-080	3.0	9.0	16.0	80.0
HSK63A-TS03-160	3.0	9.0	22.0	160.0
HSK63A-TS04-080	4.0	10.0	17.0	80.0
HSK63A-TS04-160	4.0	10.0	22.0	160.0
HSK63A-TS05-080	5.0	11.0	18.0	80.0
HSK63A-TS05-160	5.0	11.0	22.0	160.0
HSK63A-TT06-080	6.0	20.0	27.0	80.0
HSK63A-TT06-120	6.0	20.0	27.0	120.0
HSK63A-TT06-160	6.0	20.0	27.0	160.0
HSK63A-TT08-080	8.0	20.0	27.0	80.0
HSK63A-TT08-120	8.0	20.0	27.0	120.0
HSK63A-TT08-160	8.0	20.0	27.0	160.0
HSK63A-TT10-085	10.0	24.0	32.0	85.0
HSK63A-TT10-120	10.0	24.0	32.0	120.0
HSK63A-TT10-160	10.0	24.0	32.0	160.0
HSK63A-TT12-090	12.0	24.0	32.0	90.0
HSK63A-TT12-120	12.0	24.0	32.0	120.0
HSK63A-TT12-160	12.0	24.0	32.0	160.0

HSK63A Heat Shrink Holders

CODE	D	d1	d2	L
HSK63A-TT14-090	14.0	27.0	34.0	90.0
HSK63A-TT14-120	14.0	27.0	34.0	120.0
HSK63A-TT14-160	14.0	27.0	34.0	160.0
HSK63A-TT16-095	16.0	27.0	34.0	95.0
HSK63A-TT16-120	16.0	27.0	34.0	120.0
HSK63A-TT16-160	16.0	27.0	34.0	160.0
HSK63A-TT18-095	18.0	33.0	42.0	95.0
HSK63A-TT18-160	18.0	33.0	42.0	160.0
HSK63A-TT20-100	20.0	33.0	42.0	160.0
HSK63A-TT20-160	20.0	33.0	42.0	160.0
HSK63A-TT25-115	25.0	44.0	52.6	115.0
HSK63A-TT25-160	25.0	44.0	52.6	160.0
HSK63A-TT32-160	32.0	44.0	52.6	160.0

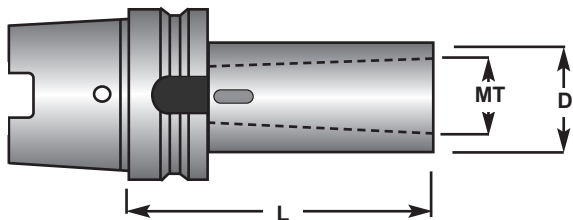

HSK63A Morse Taper Adaptors

CODE	MT	D	L
HSK63A-MT2-120	2	32.0	120.0
HSK63A-MT3-140	3	40.0	140.0
HSK63A-MT4-160	4	48.0	160.0

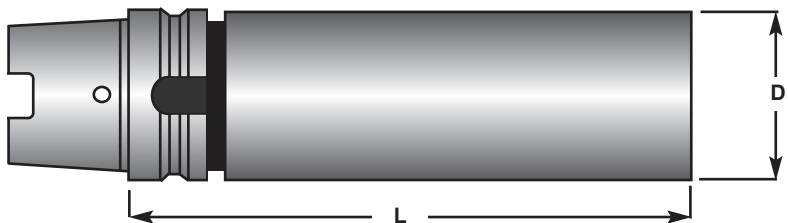

HSK63A ER (DIN6499) Greenstock Blank

CODE	D	L
HSK63A-BB063-250	63.0 Dia	250.0